

REPORT TO COUNCIL



Date: February 29, 2012
To: City Manager
From: Land Use Management, Community Sustainability (DN)
Application: DP10-0099 **Owner:** New Town Architecture Services
Address: 5300 Main Street **Applicant:** Tree Tops (Kettle Valley) Developments Ltd.
Subject: Extension Request
Zone: CD2 - Kettle Valley Comprehensive Residential Development

THAT in accordance with Development Application Procedures Bylaw No. 10540, the deadline for the issuance of Development Permit DP10-0099 (Lot A Section 23 Township 28 SDYD Plan KAP80574, located at 5300 Main St, Kelowna, BC), be extended from March 20, 2012 to September 20, 2012.

Land Use Management

Council considered and supported the Development Permit application at the regular Council meeting of September 20, 2010.

Section 2.12.1 and 2.12.2 of Procedure Bylaw No. 10540 states that:

Renewal and extension of development permits that have been authorized for issuance or have been issued provided:

- (i) The term of authorization for issuance of the Development Permit does not exceed 12 months for the original date of authorization for issuance of the Development Permit; and
- (ii) The term of issuance of the Development Permit does not exceed 2 years from the original date of issuance of the Development Permit.
- (iii) Upon written request by the applicant prior to the lapse of the application, Council may extend the deadline for a period of six (6) months by passing a resolution to that affect.

The Land Use Management Department recognizes that the marketplace is in a unique economic climate at this time, and this may influence the viability of some in-stream development projects. Accordingly, the applicant wishes to have this application remain

A handwritten signature in blue ink, appearing to be a stylized 'R' or similar character.

open for an additional six months. Notably, this is the final extension that may be processed for this file as the 2 year time limitation will expire on September 20, 2012.

This project remains unchanged and is the same in all respects as originally applied for.

Report prepared by:



Danielle Noble
Manager, Urban Land Use Management

Approved for Inclusion:



Shelley Gambacort, Director, Land Use Management

/hb

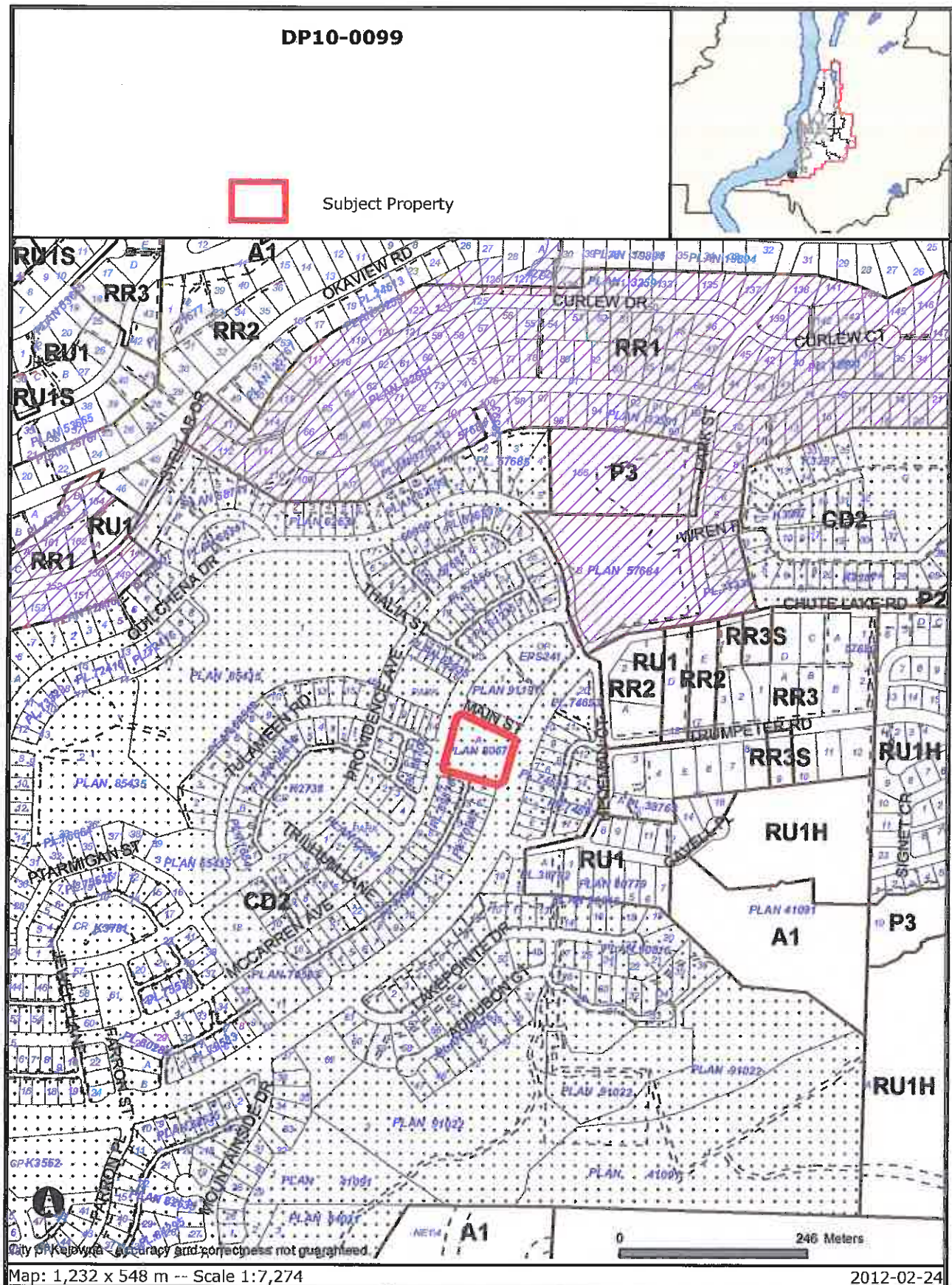

Certain layers such as lots, zoning and dp areas are updated bi-weekly. This map is for general information only.
 The City of Kelowna does not guarantee its accuracy. All information should be verified.